

Technical drawing of a window frame assembly. The drawing includes a side elevation and a top-down view of the frame.

Side Elevation Dimensions:

- Overall width: 1550
- Side offsets: 250 (left and right)
- Inner width: 1050
- Height: 1470
- Top offset: 73
- Bottom offset: 73

Top-Down View Dimensions:

- Overall width: 1550
- Side offsets: 250 (left and right)
- Inner width: 1050
- Height: 1470
- Top offset: 73
- Bottom offset: 73

Component Callouts:

- 31** $\varnothing 16$ 150: Callout for the main frame profile.
- 35** $\text{Tr} \varnothing 16$ 450: Callout for the top rail profile.
- 37** $\text{Tr} \varnothing 16$ 150: Callout for the side rail profile.
- 31** $\varnothing 16$ 147: Callout for the vertical muntin profile.
- 31** $\varnothing 16$ 16: Callout for the horizontal muntin profile.
- 37** $\text{Tr} \varnothing 16$ 150: Callout for the bottom rail profile.

Technical drawing of a rectangular building footprint, showing dimensions and reinforcement details. The drawing includes a plan view and a cross-section view.

Plan View Dimensions:

- Overall width: 6000
- Overall length: 5850
- Internal width (between columns): 4950
- Column spacing (center-to-center): 525
- Column diameter: $\varnothing 16$
- Reinforcement details: $\varnothing 16/150$ (top and bottom), $\varnothing 16/138$ (middle), $\varnothing 16/145$ (left and right edges), $\varnothing 16/450$ (top and bottom edges).

Cross-Section View Dimensions:

- Overall height: 1261
- Internal height (between columns): 1104
- Column height: 83
- Column diameter: $\varnothing 16$
- Reinforcement details: $\varnothing 16/150$ (top and bottom), $\varnothing 16/138$ (middle), $\varnothing 16/145$ (left and right edges), $\varnothing 16/450$ (top and bottom edges).

Technical drawing of a rectangular frame with dimensions and callouts. The drawing shows a top-down view of a rectangular frame with a central rectangular opening. The overall dimensions are 800 (width) and 141 (height). The frame is composed of two main sections, each 72 units high. The central opening is 450 units wide and 141 units high. The frame has a thickness of 150 units. Callouts include: 31) 4ø16 (top and bottom horizontal sections), 36) Trø16 (vertical sections), and 37) 9ø16 (central opening). Dimensions are given in millimeters (mm).

Technical drawing of a tapered cylindrical vessel with a conical bottom. The drawing includes front and side views with dimensions and callouts.

Front View Dimensions:

- Top diameter: $\phi 16150$ (Callout 33)
- Bottom diameter: $\phi 16118$ (Callout 32)
- Height: 1115
- Top flange thickness: 86
- Bottom flange thickness: 84
- Top flange width: 75
- Bottom flange width: 75

Side View Dimensions:

- Top diameter: $\phi 16150$ (Callout 33)
- Bottom diameter: $\phi 16145$ (Callout 32)
- Height: 1160
- Top flange thickness: 85
- Bottom flange thickness: 83
- Top flange width: 75
- Bottom flange width: 75

Callouts:

- 33: $\phi 16150$
- 32: $\phi 16118$
- 32: $\phi 16145$
- 36: Tr4 $\phi 16/150$

PRŮMĚR PRUTU

dr	
$\phi \leq 16$	4 D
$\phi > 16$	7 D

$\geq 10\phi$
 $\geq 70\text{mm}$

$\geq 50\text{mm}$

ZPŮSOB KÓTOVÁNÍ VLOŽEK:

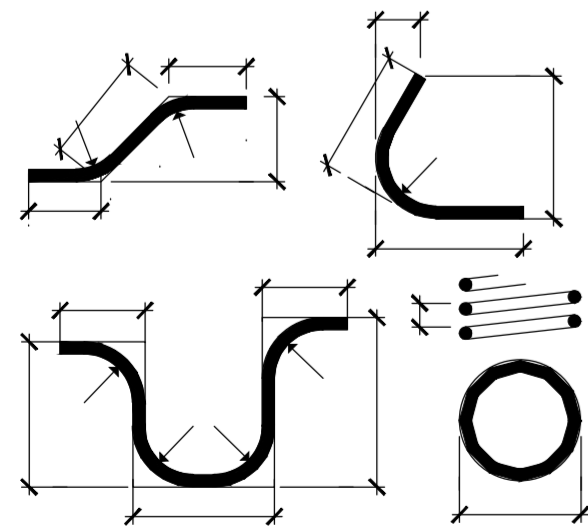

C25/30-XF2,XD1

B 500B

40mm
50mm

5800

31) $\emptyset 16$; L=5800mm; 128ks

465

790

465

475

665

475

505

130

130

785

785

700

150

770

770

32) $\emptyset 16$; L=1650mm; 128ks

33) $\emptyset 16$; L=1650mm; 128ks

475

790

465

34) $\emptyset 16$; L=2300mm; 36ks

475

1415

475

35) $\emptyset 16$; L=2750mm; 160ks

1450

135

785

785

490

36) $\emptyset 16$; L=3150mm; 160ks

1:25



m 0.25 0.50 0.75 1.00 1.25

SO 182 DSPS

SOUHRADNÍČNÝ SYSTÉM: S-UTSK		DPS	
VÝŠKOVÝ SYSTÉM: BpV			
KRESLIL:	KOLEKTIV	 FÖRSTEROVA Č.P. 175, 566 01 VYSOKÉ MÝTO EMAIL: MOS@MDSPROJEKT.CZ	
ZPRACOVÁL:	ING. FRANTIŠEK ČERNÍK		
TECHNICKÁ KONTROLA:	ING. JAN BURSA		
ZODPOVĚDNÝ PROJEKTANT:	ING. FRANTIŠEK ČERNÍK		
HLAVNÍ PROJEKTANT:	ING. JAN BURSA		
KRAJ: PARDUBICE	OKRES: PARDUBICE	OBC: KLADUBOV M.L., ŘEČANY M.L.	
INVESTOR: PARDUBICKÝ KRAJ, KOMENSKÉHO NÁMĚSTÍ 125, 532 11 PARDUBICE		STUPEŇ:	DPS
AKCE:		ZAK.ČÍSLO:	2885-23-4
MODERNIZACE MOSTU EV.Č. 3227-3 ŘEČANY NAD LABEM OBJEKT: SO 182 - DOČASNÉ PRAVNÍ OPATŘENÍ		ARCHIVNÍ ČÍSLO:	2885
		DATUM:	10/2023
		FORMÁT:	6x4
		NEŘÍTKO:	1:25
		ČÍSLO SOUPRAVY:	ČÍSLO PŘÍLOHY:
OBSAH:			12.
VÝZTUŽ KŘÍDEL			